

RIVER → LAND

Reimagining Butler's Wharf
Hayatsu Architects & Stinsensqueeze

Connecting the river with the land by bringing content from the river bed on to the jetty, and using the jetty to talk back to the river.

LAND → RIVER



Line from low tide River Thames



Lettering following movement of water on paving



Sample of mudlarking materials found in River Thames



Sample of pebble inserts to paving



Derek Jarman's Prospect Cottage garden, Dungeness



Bankside, South Side Embankment

Patterns from water Layout for pathway

We want to capture the movement of water onto the existing paving stone surface. A new pathway weaves through planting mounds and seating boulders, arranged like islands, subsuming existing maritime objects and lamp posts giving them added prominence and purpose.

Historical narrative Along the pathway

A continuous curved line of text will be permanently imprinted onto the existing stone paving for the entire length of jetty narrating local histories, using road marking paint as application method. Specific quotes will be selected from various sources and different eras of the wharf's past.

Community involvement Mudlarking

We are interested in collecting paving materials from the river with volunteers from the local community. Stones, broken tiles, discarded small objects will be gathered through a series of workshops in order to create mosaic paving incorporated in the design.

Recycling and reimagining materials Seating, water fountains, driftwood

To continue the idea of representing the geology of the Thames, enlarged replicas of pebbles which have been eroded to form a smooth surface found on the riverbed will make up new seating and water fountains. In addition to this, driftwood is placed as vertical markers in the planters, adding height to the landscape.

Vegetation influenced by Prospect Cottage Planting

The planting bed is lined with pebbles, as in Derek Jarman's garden in Dungeness. Ground hugging sea kale, geranium and juniper are characterful and bonsai-like. Resilient and tough plants like feathery grass and sedges create low volume so as not to obstruct the view. Fragrant evergreen herbs like lavender, prostrate rosemary and hyssop attract insects.

Moment of reflection and play Sound sculpture, quote on river, seating

To encourage play and reflection across all ages, simple intervention are placed along the area. A sound sculpture where one can listen to the water just below, a typographic message facing the river and increased capacity of seating results in moments of reflection.

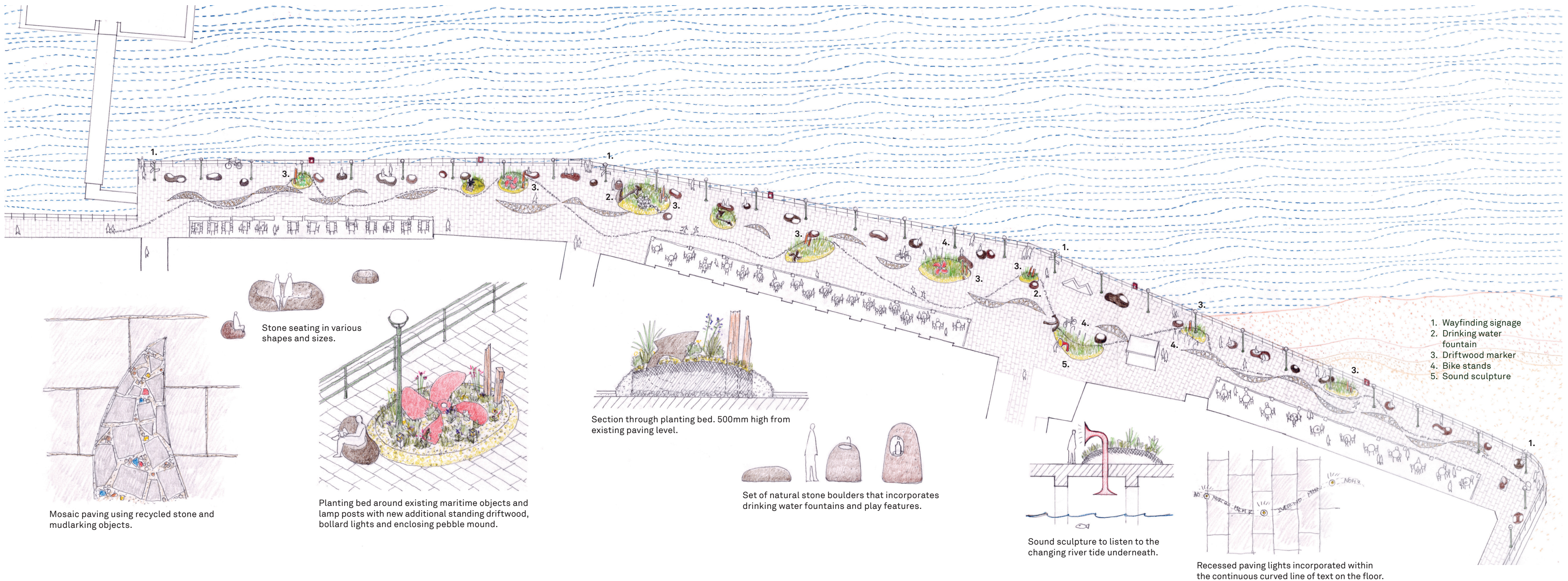

Mosaic paving using recycled stone and mudlarking objects.

Planting bed around existing maritime objects and lamp posts with new additional standing driftwood, bollard lights and enclosing pebble mound.

Section through planting bed. 500mm high from existing paving level.

Set of natural stone boulders that incorporates drinking water fountains and play features.

Sound sculpture to listen to the changing river tide underneath.

Recessed paving lights incorporated within the continuous curved line of text on the floor.

LAND → RIVER

Reimagining Butler's Wharf
Hayatsu Architects & Stinsensqueeze

Connecting the river with the land by bringing content from the river bed on to the jetty, and using the jetty to talk back to the river.

RIVER → LAND



Morning view towards Canary Wharf



Dusk view towards Tower Bridge

Preserve and enhance existing
Mosaic paving, maritime objects, lighting

Existing stone pavers will be reused for the new mosaic pattern on the floor by breaking it into smaller pieces, to be mixed together with the mudlarking findings. Existing maritime objects stay where they are and are incorporated into the new planting beds.

Existing lamp posts to be reinstated using solar energy sourced LED lamps. New low level bollard lights in the planters and floor recessed path lights along the text line illuminate the jetty, adding more ambient light.



Section perspective showing the relationship between the river bed and new treatments to the jetty

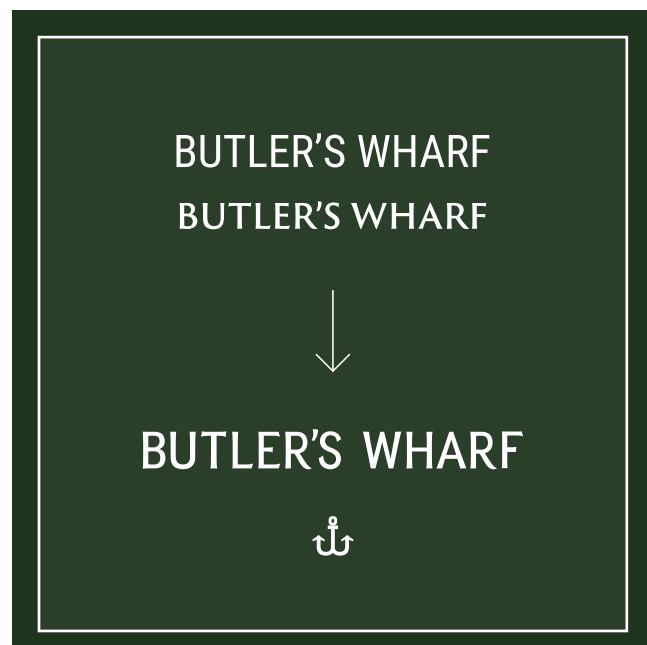

The process of Butler's Wharf logo, typeface and symbol.
New brand colour forest green

Connecting past to present
Graphic identity, typeface, signage

Following the same logo / letterform construction process as that used for the development of the Blue Market Bermondsey logo, the new logo for Butlers Wharf merges letterforms from different periods of time. Looking closely at the letterforms currently found on the Butlers Wharf buildings and structures of past letters forms found in stone carving around the borough. To avoid adding new structures to the site for economical, environmental reasons, the idea for way finding and viewing points is that the signs are attached to existing lamp posts and railings.

For all typographic stories we would like to collaborate with Bermondsey based storytellers Vanessa Woolf and Nigel of Bermondsey.



Wayfinding on existing lamp posts



Viewing points signage on existing railing

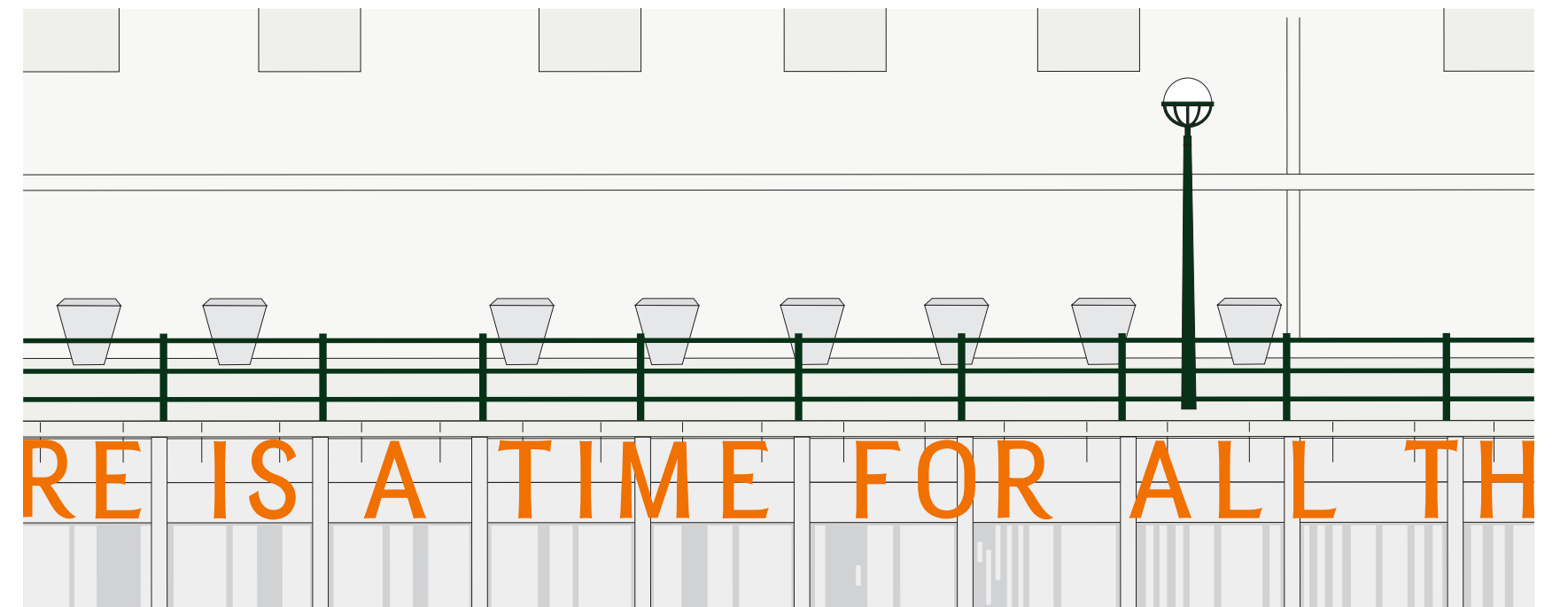

Quote facing river 'There is a Time for all Things' (William Shakespeare)